

Stal nierdzewna [A4]
Polerowany

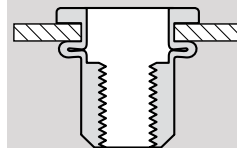
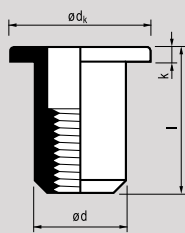

MASTERGRIP | otwarte | kołnierz cylindryczny

$\emptyset d$		l [+0,5/-0]		Indeks nr.	$\emptyset dk$ [+0/-0,5]	k \leq	$\emptyset d$ [+0/-0,2]			
[mm]		[mm]	[mm]		[mm]	[mm]	[mm]	[Nm]	[N]	[N]
M5	*	13,0	0,5-3,0	28M05CO1	10,0	1,1	6,9	12,0	11.760	3.920
$\emptyset 7,0$										
M6	*	16,0	0,5-3,0	28M06CO1	12,0	1,6	8,9	22,2	20.580	5.630
$\emptyset 9,0$										
M8	*	17,5	0,5-3,0	28M08CO1	15,0	1,6	10,9	30,5	26.460	7.800
$\emptyset 11,0$										

=	brak zmian technicznych
!	uwaga - zmiany techniczne
*	nowość w programie nitonakrętek