

Magna-Bulb® Blind Fastener

A high strength blind fastener that produces a wide blind side footprint specifically designed for fastening thin sheet metal, giving a strong joint with enhanced pull through qualities. Magnabulb also comes with the "Huck Solid Circle Locking System".

This product is T.I.R. approved.

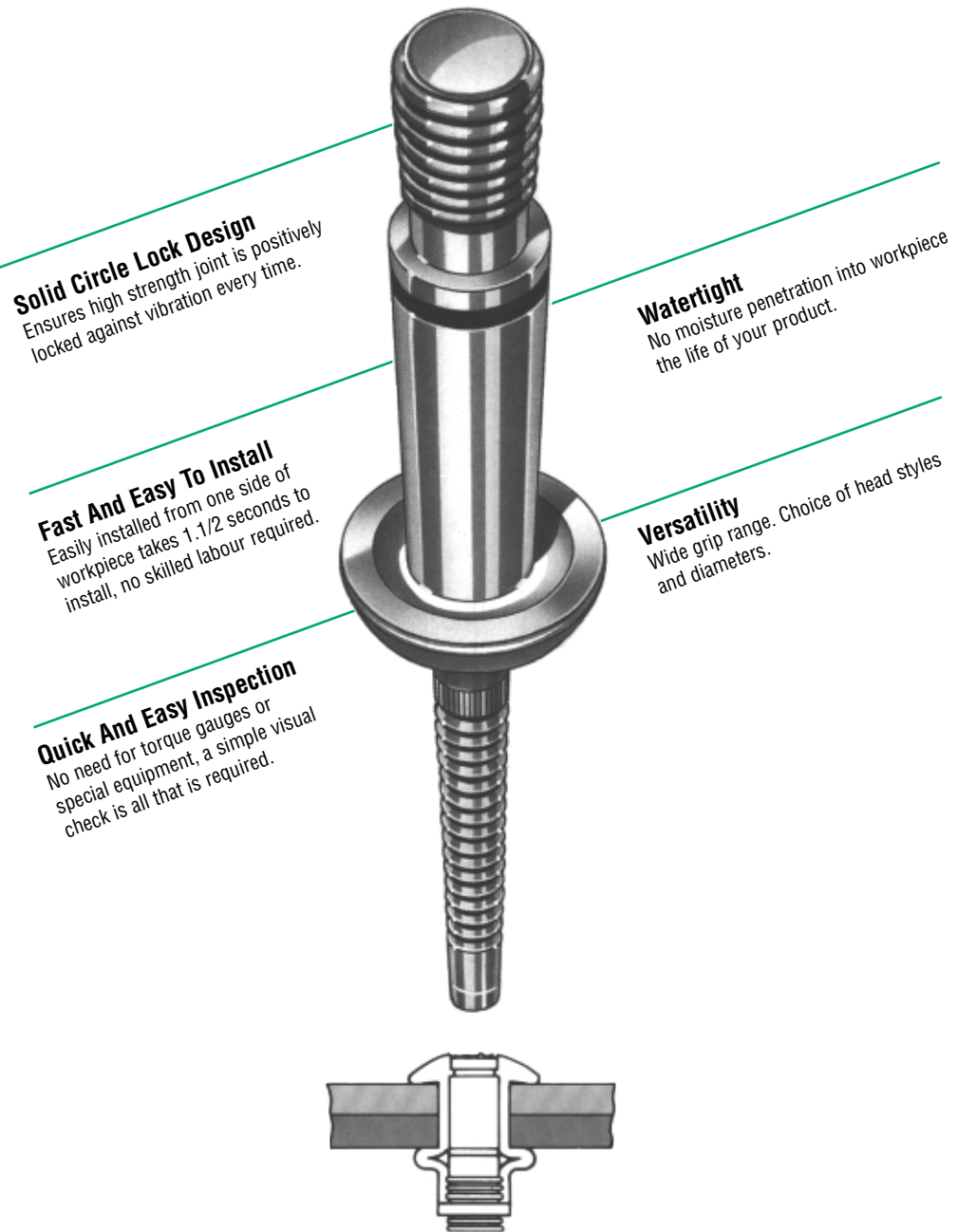

Solid Circle Lock Design
Ensures high strength joint is positively locked against vibration every time.

Watertight
No moisture penetration into workpiece the life of your product.

Fast And Easy To Install
Easily installed from one side of workpiece takes 1.1/2 seconds to install, no skilled labour required.

Versatility
Wide grip range. Choice of head styles and diameters.

Quick And Easy Inspection
No need for torque gauges or special equipment, a simple visual check is all that is required.

APPLICATIONS

- Commercial vehicle body building ■ buses ■ trains
- general sheet metal fabrication ■ ideally suited for automotive applications

Magna-Bulb® Blind Fastener

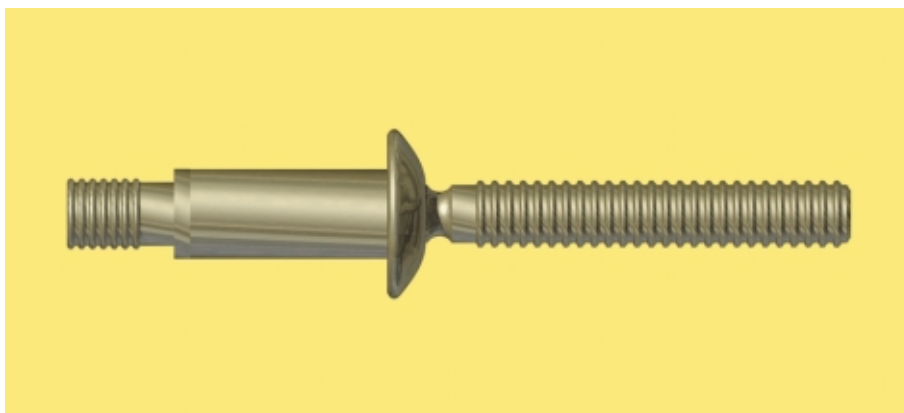

Fastener Specifications

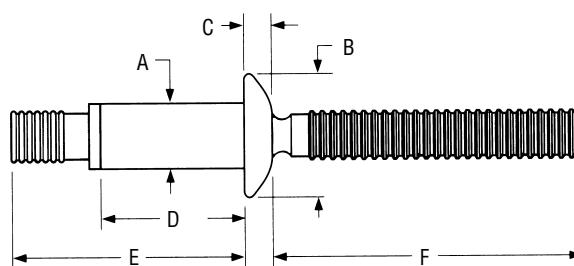

Dia.	Part No.	Grip Range	Hole Size	A nom	B max	C max	D _{s0.18}	E max	F min
4.8 (3/16")	MBP-R6-M1	1.02 - 2.41	4.85 - 5.11	4.75	9.78	2.57	8.89	15.80	25.40
	MBP-R6-M2	1.19 - 2.79	4.85 - 5.11	4.75	9.78	2.57	8.89	15.80	25.40
	MBP-R6-M3	2.21 - 3.81	4.85 - 5.11	4.75	9.78	2.57	9.91	16.79	25.40
	MBP-R6-M4	3.20 - 4.80	4.85 - 5.11	4.75	9.78	2.57	10.90	17.81	25.40
	MBP-R6-M5	4.19 - 5.79	4.85 - 5.11	4.75	9.78	2.57	11.89	18.85	25.40
	MBP-R6-M6	5.21 - 6.81	4.85 - 5.11	4.75	9.78	2.57	12.90	19.86	25.40
	MBP-R6-M7	6.20 - 7.80	4.85 - 5.11	4.75	9.78	2.57	13.89	20.85	25.40
	MBP-R6-M8	7.19 - 8.81	4.85 - 5.11	4.75	9.78	2.57	14.91	21.87	25.40
	MBP-R6-M9	8.20 - 9.80	4.85 - 5.11	4.75	9.78	2.57	15.90	22.86	25.40
	MBP-R6-M10	9.19 - 10.80	4.85 - 5.11	4.75	9.78	2.57	16.89	23.85	25.40
6.4 (1/4")	MBP-R8-M2	1.52 - 3.51	6.63 - 6.91	6.38	13.46	3.18	11.48	20.07	27.94
	MBP-R8-M3	2.79 - 4.80	6.63 - 6.91	6.38	13.46	3.18	12.75	22.61	27.94
	MBP-R8-M4	3.81 - 5.82	6.63 - 6.91	6.38	13.46	3.18	13.77	23.19	27.94
	MBP-R8-M5	4.80 - 6.81	6.63 - 6.91	6.38	13.46	3.18	14.76	23.88	27.94
	MBP-R8-M6	5.82 - 7.82	6.63 - 6.91	6.38	13.46	3.18	15.77	25.40	27.94
	MBP-R8-M7	6.81 - 8.79	6.63 - 6.91	6.38	13.46	3.18	16.76	26.42	27.94
	MBP-R8-M8	7.82 - 9.83	6.63 - 6.91	6.38	13.46	3.18	17.78	27.43	27.94
	MBP-R8-M9	8.79 - 10.80	6.63 - 6.91	6.38	13.46	3.18	18.77	28.45	27.94
	MBP-R8-M10	9.83 - 11.84	6.63 - 6.91	6.38	13.46	3.18	19.79	29.46	27.94
	MBP-R8-M11	10.80 - 12.80	6.63 - 6.91	6.38	13.46	3.18	20.78	30.48	27.94
	MBP-R8-M12	11.84 - 13.84	6.63 - 6.91	6.38	13.46	3.18	21.79	31.50	27.94
	MBP-R8-M13	12.80 - 14.81	6.63 - 6.91	6.38	13.46	3.18	22.78	32.51	27.94
	7.9 (5/16")	MBP-R10-3	3.81 - 6.35	8.32 - 8.64	8.03	16.64	3.86		28.32

Typical Installed Values in Nominal Grip (N)

Diameter	Shear	Tensile	Pin Retention
4.8 mm (3/16")	7560	4890	667
6.4 mm (1/4")	16010	8900	1334
7.9 mm (5/16")	22240	13340	2091

Materials and Finishes

	Material	Finish
Sleeve	Steel	Zinc Plated with Gold Chromate
Pin	Steel	Zinc Plated with Gold Dichromate

How to Order

To order Magna-Bulb fasteners, specify the part number from the Fastener Specifications table above.

Magna-Bulb® Installation Tooling

Huck Installation Tools

Huck installation tools consist of a nose assembly and a tool. The choice of tool and nose assembly is determined by the fastener diameter and application.

Tools and nose assemblies are easily changed as installation requirements demand. Huck offers pneumatic and hydraulic installation tools.

Pneumatic tools operate on 6.2-6.9 bar (90-100 psi) air pressure.

The lighter weight hydraulic tools operate on hydraulic power supplied by a Huck POWERIG® Hydraulic Unit.

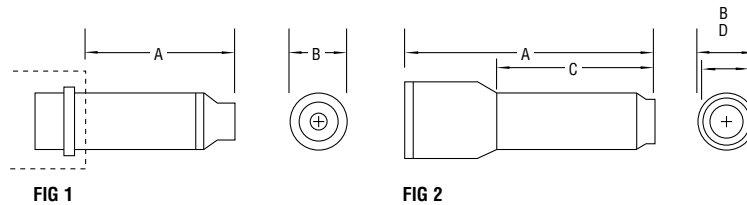

Code	Diameter	Nose Ass.	Fig.	A mm	B mm	C mm	D mm	Pneumatic Tooling	Hydraulic Tooling
6	4.8 mm (3/16")	99-3300	1	49.3	19.1	-	-	2025 / 2025V / LH-224	2480
		99-3303	1	55.9	19.1	-	-	2025 / 2025V / LH-224	2480
		99-3303L	1	55.9	19.1	-	-	2025L	2480L
		99-3304	1	157.5	19.1	-	-	2025 / 2025V / LH-224	2480
				Nose Assembly integral with Tool				241E	-
8	6.4 mm (1/4")	99-3301	1	49.3	19.1	-	-	2025 / 2025V / LH-224	2480
		99-3305	1	50.1	19.1	-	-	2025 / 2025V / LH-224	2480
		99-3305L	1	50.1	19.1	-	-	2025L	2480L
		99-3306	1	157.5	19.1	-	-	2025 / 2025V / LH-224	2480
				Nose Assembly integral with Tool				241E	-
10	7.9 mm (5/16")	99-3307	2	91.7	27.3	56.0	23.9	245 / 246 / 255 / 256	2503

Items in **bold** are part of our FOCUS Tooling Range

Note: Other tool and nose assembly combinations may be available for specific applications. Please contact Huck for details.

Installation Sequence

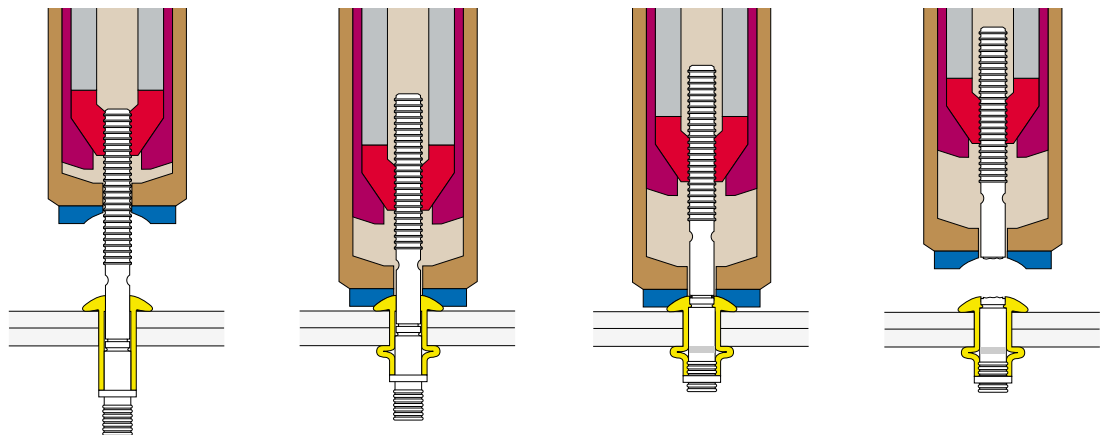

[Click Here to view animation of installation sequence](#)